

Schülpke

**Stempel und Matrizen
passend für Stanzen und Profilstahlscheren
des Fabrikates Peddinghaus**

*Punches and Dies
suitable for punches and section shears
of the brand Peddinghaus*





Die in diesem Katalog genannten Preise sind Grundpreise in EURO, bei Wiederverkauf durch den Handel jedoch unverbindliche Preisempfehlungen. Die Mehrwertsteuer ist in den Preisen nicht enthalten und wird separat ausgewiesen.

Für Zwischenabmessungen und abweichendes Schneidspiel wird ein Aufpreis pro Stempel und pro Matrize berechnet.

Preisstellung: ab Werk; ausschl. Verpackung.

Um Ihren Auftrag schnell, genau und mit der nötigen Sorgfalt zu bearbeiten, bitten wir Sie, folgende Punkte zu prüfen bzw. zu beachten:

- passen die gewünschten Stempel und Matrizen in die Werkzeugaufnahme der vorhandenen Maschinen. Form und Abmessung der Stempel und Matrizen sind auf den Katalogseiten ersichtlich, eventuell bitte an vorhandenen Werkzeugen prüfen.
- ist das Eckenmaß der zu stanzenden Form nicht größer als der Schaftdurchmesser des Stempels.
- sind Reduzierungen von einer größeren Vorrichtung auf die gewünschten kleineren Stempel und Matrizen vorhanden.
- Bei Stempeln und Matrizen, die von der Katalognorm und -form abweichen, geben Sie bitte die zu bearbeitende Materialstärke und -qualität an.

Damit sich die Lebensdauer von Stempeln und Matrizen verlängert und die Stanzqualität verbessert wird, sollten folgende Punkte beachtet werden:

- richtiges Schneidspiel zwischen Stempel und Matrize, d. h. 10 % der Materialstärke (bei Sondermaterial eventuell Rücksprache)
- beim Einbau der Werkzeuge auf gleichmäßiges Spiel zwischen Stempel und Matrize achten.
- beim Stanzen mit Stempelsprühgeräten arbeiten oder den Stempel manuell mit Stanzöl bestreichen.
- bei Formstempeln muss der mitgelieferte Verdrehungsstift eingebaut werden.
- Stempel und Matrize müssen fest und sicher in der Vorrichtung eingebaut sein (Fingerschutzkappe anbringen).
- der Abstreifer muss parallel zur Matrizenoberfläche sein, bei höhenstellbaren Abstreifern, nahe an Materialoberfläche absenken.
- der Stempeldurchmesser darf nicht kleiner sein, wie die vorhandene Materialstärke.
- zum Schutz von Maschine und Werkzeug sollte die benötigte Stanzkraft nach folgender Formel überprüft werden: Lochumfang x Materialstärke x Materialfestigkeit.

Wir stehen Ihnen bei Fragen jederzeit gerne zur Verfügung.
Katalog Nr. 4, Ausgabe 2015

The prices listed in this catalogue are basic prices in EURO, upon resale by trade they are non-binding price recommendations. The VAT is not included in the prices and shall be reported separately.

For intermediate dimensions and deviant die clearance an additional charge per punch and per die section is calculated

Pricing: ex works; excluding packing.

In order to process your order quickly, accurately and with due care, we encourage you to check and note the following points:

- *do the desired punches and dies fit in the tool holder of the existing machines. Shape and dimensions of the punches and dies are shown on catalogue pages, you may check on existing tools.*
- *is the maximum width across corners of the form to be punched not greater than the shaft diameter of the punch*
- *are reductions of a larger device available on the desired smaller punches and dies.*
- *for punches and dies that differ from the catalogue standard and shape, please provide the material strength and quality to be processed.*

In order to prolong the lifetime of punches and dies and to improve the die-cutting quality, the following points should be noted:

- *proper die clearance between punch and die, i.e. 10% of the material thickness (for special material consulting may be required)*
- *when installing the tools please ensure an even match between punch and die.*
- *while punching please work with stamp spraying equipment or coat the stamp manually with punching oil.*
- *at form stamps, the supplied twist pin must be installed.*
- *punch and die must be installed firmly and securely in the device (attach finger protection flap).*
- *the scraper must be parallel to the die surface, in height-adjustable scrapers, lower close to the material surface.*
- *the punch diameter shall be not smaller than the existing material thickness.*
- *in order to protect the machine and the tool, the cutting force required should be checked using the following formula: hole circumference x material thickness x material strength*

*We remain at your disposal for any further questions
Catalogue no. 4, edition 2015*

VERWENDUNGSÜBERSICHT / USE OVERVIEW

für Schülpkpe Stempel und Matrizen passend für Lochstanzen des Fabrikates Peddinghaus
for Schülpkpe punches and dies suitable for hole punches of the brand Peddinghaus

Modellreihe A <i>Model series A</i> Stempel / Punch Nr. 1 + 4 Matrize / Die Nr. 2 + 13	Schülpkpe Stempel und Matrizen zur Schnellspann-Vorrichtung <i>Schülpkpe punches and dies for quick-change punching attachment</i>	
	Modelle der älteren Generation / Older machine types	
	Peddicat 360	Forax 15 * 25 * 45 * 65
	Peddiworker 400 * 500 * 600 * 800	Forax 150 * 250 * 450
	Peddimaster 450 M * 28/40 * 40/60 * 60/80 * 60/100 * 80/110	Stanzfix
	Hydraulic 40 * 60N * 300 * 400 * 500 * 600	225 B/ 11 * 13 * 45 * 60
210 Super/Standard 11 * 13	225 H/ 11 * 13	
Modellreihe B <i>Model series B</i> Stempel / Punch Nr. 2 + 5 Matrize / Die Nr. 3 + 14	Schülpkpe Stempel und Matrizen zur Schnellspann-Vorrichtung <i>Schülpkpe punches and dies for quick-change punching attachment</i>	
	Heutige Generation/Current generation	Ältere Generation / Older machine types
	Peddibasic No. 1	Peddicat 361 * 380 * 500
	Peddicat No. 1	Peddiworker 501 * 502 * 801 * 802 * 1000 G
	Peddiworker No. 1	Peddimaster 100/160 * 110/170 * 800/1100 * 1100/1700
	Hydraulic 280 * 502 * 801	Peddimax 600 * 601 * 602 * 800 * 801 * 1002 * 110/140
		Hydraulic 100 * 301 * 501 * 800 * 1000 * 1001
		210 Super 16 * 20 * 210 Standard 16
		Forax 80 * 100 * 1000
		225 B/ 16 * 20 * 80 * 100 22 H/ 15 * 20
Modellreihe C <i>Model series C</i> Stempel / Punch Nr. 3 + 6 + 7 + 11 Matrize / Die Nr. 4 +6 +20	Schülpkpe Stempel und Matrizen für Sonder-Stanzvorrichtungen <i>Schülpkpe punches and dies for oversize punching attachments</i>	
	Modelle / Model	
	210 Super 25 * Peddimax No. 1	
	225 B/ 25 * 130	
	Hydraulic 140z *1000N*1400N* 1250	
Für Sonderstanzvorrichtungen bis 39 * 58 * 65 * 90 mm Ø zu allen o. g. Modellen <i>suitable for oversize punching attachments up to 39* 58* 65* 90 mm for all above mentioned model</i>		

Wichtig !!!

Da Ihre Stanze eventuell mit einer Sonderstanzvorrichtung ausgerüstet ist, vergleichen Sie bitte bei jeder Bestellung die Aussenmaße der vorhandenen Werkzeuge mit den Maßangaben in diesem Katalog.

Important !!!

Because your punch is possibly equipped with an oversize attachment, please compare for each order the outer dimentions of the existing tools with the stated dimentions in this catalogue.

Modellreihe A / Model series A

Rundstempel
round punch

Nr. 1



d=	Best.-Nr.
3.0	RST1-0030
3.2	RST1-0032
3.5	RST1-0035
4.0	RST1-0040
4.2	RST1-0042
4.5	RST1-0045
5.0	RST1-0050
5.5	RST1-0055
6.0	RST1-0060
6.5	RST1-0065
7.0	RST1-0070
7.5	RST1-0075
8.0	RST1-0080
8.5	RST1-0085
9.0	RST1-0090
9.5	RST1-0095
10.0	RST1-0100
10.5	RST1-0105
11.0	RST1-0110
11.5	RST1-0115
12.0	RST1-0120
12.5	RST1-0125
13.0	RST1-0130
13.5	RST1-0135
14.0	RST1-0140

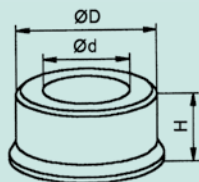

Reduzierhülse 1/4
reducing sleeve 1/4

RDH 07.5611

Abmessungen: Seite 7b
Dimensions: Page 7b

Rundstempel
round punch

Nr. 4



d=	Best.-Nr.
8.0	RST4-0080
8.5	RST4-0085
9.0	RST4-0090
9.5	RST4-0095
10.0	RST4-0100
10.5	RST4-0105
11.0	RST4-0110
11.5	RST4-0115
12.0	RST4-0120
12.5	RST4-0125
13.0	RST4-0130
13.5	RST4-0135
14.0	RST4-0140
14.5	RST4-0145
15.0	RST4-0150
15.5	RST4-0155
16.0	RST4-0160
16.5	RST4-0165
17.0	RST4-0170
17.5	RST4-0175
18.0	RST4-0180
18.5	RST4-0185
19.0	RST4-0190
19.5	RST4-0195
20.0	RST4-0200
20.5	RST4-0205
21.0	RST4-0210
21.5	RST4-0215
22.0	RST4-0220
22.5	RST4-0225
23.0	RST4-0230
23.5	RST4-0235
24.0	RST4-0240
24.5	RST4-0245
25.0	RST4-0250
25.5	RST4-0255
26.0	RST4-0260

Rundmatrize
round die

Nr. 2

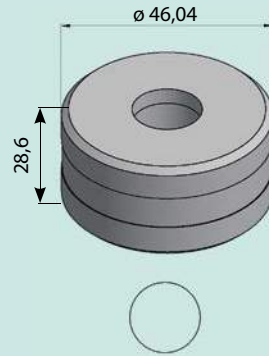

d=	Best.-Nr.	d=	Best.-Nr.
3.2	RMA2-0032	11.2	RMA2-0112
3.4	RMA2-0034	11.7	RMA2-0117
3.7	RMA2-0037	12.2	RMA2-0122
4.2	RMA2-0042	12.7	RMA2-0127
4.4	RMA2-0044	13.2	RMA2-0132
4.7	RMA2-0047	13.7	RMA2-0137
5.2	RMA2-0052	14.2	RMA2-0142
5.7	RMA2-0057	14.7	RMA2-0147
6.2	RMA2-0062	15.2	RMA2-0152
6.7	RMA2-0067	15.7	RMA2-0157
7.2	RMA2-0072	16.2	RMA2-0162
7.7	RMA2-0077	16.7	RMA2-0167
8.2	RMA2-0082	17.2	RMA2-0172
8.7	RMA2-0087	17.7	RMA2-0177
9.2	RMA2-0092	18.2	RMA2-0182
9.7	RMA2-0097	18.7	RMA2-0187
10.2	RMA2-0102	19.2	RMA2-0192
10.7	RMA2-0107	19.7	RMA2-0197
		20.2	RMA2-0202
		20.7	RMA2-0207
		21.2	RMA2-0212
		21.7	RMA2-0217
		22.2	RMA2-0222
		22.7	RMA2-0227
		23.2	RMA2-0232
		23.7	RMA2-0237
		24.2	RMA2-0242
		24.7	RMA2-0247
		25.2	RMA2-0252
		25.7	RMA2-0257
		26.2	RMA2-0262
		26.7	RMA2-0267
		27.2	RMA2-0272
		27.7	RMA2-0277
		28.2	RMA2-0282
		28.7	RMA2-0287
		29.2	RMA2-0292
		29.7	RMA2-0297
		30.2	RMA2-0302
		30.7	RMA2-0307

Rundstempel **Nr. 4**
round punch

d=	Best.-Nr.
27.0*	RST4-0270
28.0*	RST4-0280
29.0*	RST4-0290
30.0*	RST4-0300

* Übergröße
* Oversize

Modellreihe A / Model series A

**Winkelstahl-
Matrize**
offset die

Nr. 13

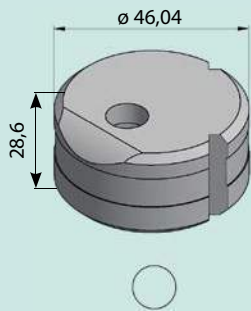

d= Best.-Nr.

5.2	WSM13-0052
5.7	WSM13-0057
6.2	WSM13-0062
6.7	WSM13-0067
7.2	WSM13-0072
7.7	WSM13-0077
8.2	WSM13-0082
8.7	WSM13-0087
9.2	WSM13-0092
9.7	WSM13-0097
10.2	WSM13-0102
10.7	WSM13-0107
11.2	WSM13-0112
11.7	WSM13-0117
12.2	WSM13-0112
12.7	WSM13-0127
13.2	WSM13-0132
13.7	WSM13-0137
14.2	WSM13-0142
14.7	WSM13-0147
15.2	WSM13-0152
15.7	WSM13-0157
16.2	WSM13-0162
16.7	WSM13-0167
17.2	WSM13-0172
17.7	WSM13-0177
18.2	WSM13-0182
18.7	WSM13-0187
19.2	WSM13-0192
19.7	WSM13-0197
20.2	WSM13-0202
20.7	WSM13-0207
21.2	WSM13-0212
21.7	WSM13-0217
22.2	WSM13-0222
22.7	WSM13-0227

**Vierkant-
Stempel**
square punch

Nr. 1

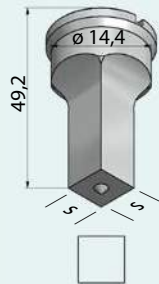

s= Best.-Nr.

4.0	VKS1-0040
5.0	VKS1-0050
6.0	VKS1-0060
7.0	VKS1-0070
8.0	VKS1-0080
9.0	VKS1-0090
10.0	VKS1-0100

**Vierkant-
Stempel**
square punch

Nr. 4

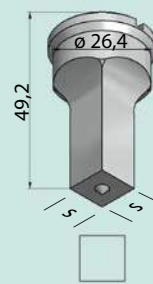

s= Best.-Nr.

11.0	VKS4-0110
12.0	VKS4-0120
13.0	VKS4-0130
14.0	VKS4-0140
15.0	VKS4-0150
16.0	VKS4-0160
17.0	VKS4-0170
18.0	VKS4-0180
19.0	VKS4-0190
20.0*	VKS4-0200
21.0*	VKS4-0210

* Übergröße
Oversize

**Vierkant-
Matrize**
square die

Nr. 2

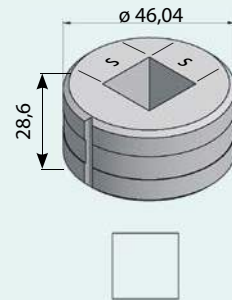

s= Best.-Nr.

4.2	VKM2-0042
5.2	VKM2-0052
5.7	VKM2-0057
6.2	VKM2-0062
6.7	VKM2-0067
7.2	VKM2-0072
7.7	VKM2-0077
8.2	VKM2-0082
8.7	VKM2-0087
9.2	VKM2-0092
9.7	VKM2-0097
10.2	VKM2-0102
10.7	VKM2-0107
11.2	VKM2-0112
11.7	VKM2-0117
12.2	VKM2-0122
12.7	VKM2-0127
13.2	VKM2-0132
13.7	VKM2-0137
14.2	VKM2-0142
14.7	VKM2-0147
15.2	VKM2-0152
15.7	VKM2-0157
16.2	VKM2-0162
16.7	VKM2-0167
17.2	VKM2-0172
17.7	VKM2-0177
18.2	VKM2-0182
18.7	VKM2-0187
19.2	VKM2-0192
19.7	VKM2-0197
20,2*	VKM2-0202
20,7*	VKM2-0207
21,2*	VKM2-0212
21,7*	VKM2-0217

Modellreihe A / Model series A

Langloch-Stempel

Nr. 1

oblong punch

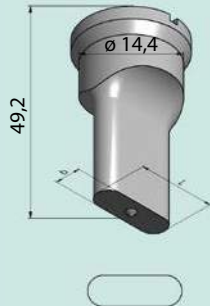

b x l **Best.-Nr.**

5,0 x 10	LST1-050100
5,0 x 14	LST1-050140
5,5 x 10	LST1-055100
5,5 x 14	LST1-055140
6,5 x 12	LST1-065120
7,5 x 14	LST1-075140
9,0 x 14	LST1-090140
10,0 x 14	LST1-100140

Langloch-Stempel

Nr. 4

oblong punch

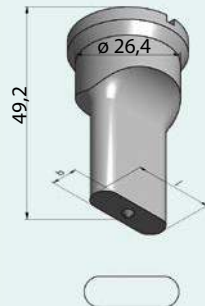

b x l **Best.-Nr.**

5,5 x 19	LST4-055190
5,5 x 25	LST4-055250
6,5 x 18	LST4-065180
6,5 x 26	LST4-065260
7,5 x 21	LST4-075210
7,5 x 26	LST4-075260
9,0 x 18	LST4-090180
9,0 x 26	LST4-090260
10,0 x 20	LST4-100200
10,0 x 26	LST4-100260
11,0 x 22	LST4-110220
11,0 x 26	LST4-110260
12,0 x 24	LST4-120240
13,0 x 26	LST4-130260
14,0 x 26	LST4-140260
16,0 x 26	LST4-160260
18,0 x 26	LST4-180260

Langloch-Matrize

Nr. 2

oblong die

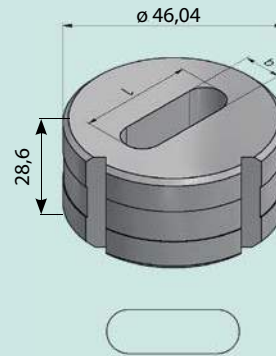

b x l **Best.-Nr.** **b x l** **Best.-Nr.**

5,2 x 10,2	LMA2-052102	12,2 x 24,2	LMA2-122242
5,7 x 10,7	LMA2-057107	12,7 x 24,7	LMA2-127247
5,2 x 14,2	LMA2-052142	13,2 x 26,2	LMA2-132262
5,7 x 14,7	LMA2-057147	13,7 x 26,7	LMA2-137267
5,7 x 10,2	LMA2-057102	14,2 x 26,2	LMA2-142262
6,2 x 10,7	LMA2-062107	14,7 x 26,7	LMA2-147267
5,7 x 14,2	LMA2-057142	16,2 x 26,2	LMA2-162262
6,2 x 14,7	LMA2-062147	16,7 x 26,7	LMA2-167267
5,7 x 19,2	LMA2-057192	18,2 x 26,2	LMA2-182262
6,2 x 19,7	LMA2-062197	18,7 x 26,7	LMA2-187267
5,7 x 25,2	LMA2-057252		
6,2 x 25,7	LMA2-062257		
6,7 x 12,2	LMA2-067122		
7,2 x 12,7	LMA2-072127		
6,7 x 18,2	LMA2-067182		
7,2 x 18,7	LMA2-072187		
6,7 x 26,2	LMA2-067262		
7,2 x 26,7	LMA2-072267		
7,7 x 14,2	LMA2-077142		
8,2 x 14,7	LMA2-082147		
7,7 x 21,2	LMA2-077212		
8,2 x 21,7	LMA2-082217		
7,7 x 26,2	LMA2-077262		
8,2 x 26,7	LMA2-082267		
9,2 x 14,2	LMA2-092142		
9,7 x 14,7	LMA2-097147		
9,2 x 18,2	LMA2-092182		
9,7 x 18,7	LMA2-097187		
9,2 x 26,2	LMA2-092262		
9,7 x 26,7	LMA2-097267		
10,2 x 14,2	LMA2-102142		
10,7 x 14,7	LMA2-107147		
10,2 x 20,2	LMA2-102202		
10,7 x 20,7	LMA2-107207		
10,2 x 26,2	LMA2-102262		
10,7 x 26,7	LMA2-107267		
11,2 x 22,2	LMA2-112222		
11,7 x 22,7	LMA2-117227		
11,2 x 26,2	LMA2-112262		
11,7 x 26,7	LMA2-117267		

Modellreihe A / Model series A

**Langloch-
Winkelstahl-
Matrize längs**

Nr. 13

oblong offset die, longitud.

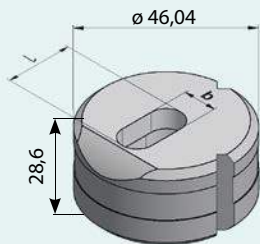

b x l Best.-Nr.

6,2 x 14,7	LWL13-062147
6,2 x 25,7	LWL13-062257
7,2 x 26,7	LWL13-072267
8,2 x 26,7	LWL13-082267
9,7 x 14,7	LWL13-097147
9,7 x 26,7	LWL13-097267
10,7 x 20,7	LWL13-107207
11,7 x 22,7	LWL13-117227
11,7 x 26,7	LWL13-117267
13,7 x 26,7	LWL13-137267
14,7 x 26,7	LWL13-147267
16,7 x 26,7	LWL13-167267

**Langloch-
Winkelstahl-
Matrize quer**

Nr. 13

oblong offset die, transv.

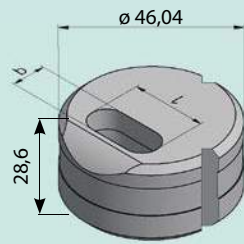

b x l Best.-Nr.

6,2 x 14,7	LWQ13-062147
6,2 x 25,7	LWQ13-062257
7,2 x 26,7	LWQ13-072267
8,2 x 26,7	LWQ13-082267
9,7 x 14,7	LWQ13-097147
9,7 x 26,7	LWQ13-097267
10,7 x 20,7	LWQ13-107207
11,7 x 22,7	LWQ13-117227
11,7 x 26,7	LWQ13-117267
13,7 x 26,7	LWQ13-137267
14,7 x 26,7	LWQ13-147267
16,7 x 26,7	LWQ13-167267

**Ecken-
Abrund-
Stempel**

Nr. 4

corner radius punch

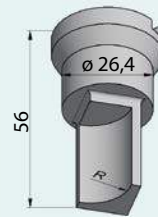

Radius Best.-Nr.

5	EAS4-000005
10	EAS4-000010
14	EAS4-000014

**Ecken-
Abrund-
Matrize**

Nr. 2

corner radiusing die

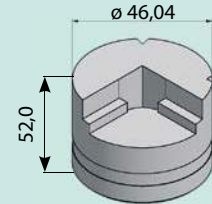

Radius Best.-Nr.

5	EAM2-000005
10	EAM2-000010
14	EAM2-000014

**Drehriegel-
Stempel
hasp hole
punch**

**Nr. 4 Drehriegel-
Matrize
hasp hole
die**

Nr. 2

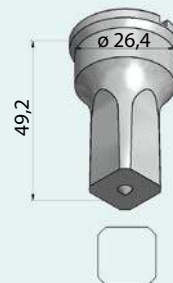

DHS4-222203

d=22,2 x 20,3

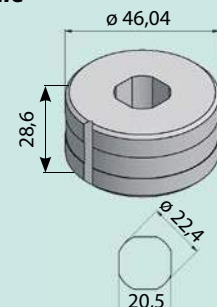

DHM2-224205

d=22,4 x 20,5

Modellreihe B / Model series B

Rundstempel round punch

Nr. 2

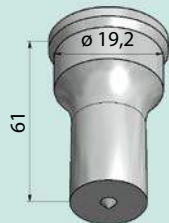

d= Best.-Nr.

3.0	RST2-0030
3.2	RST2-0032
3.5	RST2-0035
4.0	RST2-0040
4.2	RST2-0042
4.5	RST2-0045
5.0	RST2-0050
5.5	RST2-0055
6.0	RST2-0060
6.5	RST2-0065
7.0	RST2-0070
7.5	RST2-0075
8.0	RST2-0080
8.5	RST2-0085
9.0	RST2-0090
9.5	RST2-0095
10.0	RST2-0100
10.5	RST2-0105
11.0	RST2-0110
11.5	RST2-0115
12.0	RST2-0120
12.5	RST2-0125
13.0	RST2-0130
13.5	RST2-0135
14.0	RST2-0140
14.5	RST2-0145
15.0	RST2-0150
15.5	RST2-0155
16.0	RST2-0160
16.5	RST2-0165
17.0	RST2-0170
17.5	RST2-0175
18.0	RST2-0180
18.5	RST2-0185
19.0	RST2-0190

Rundstempel round punch

Nr. 5

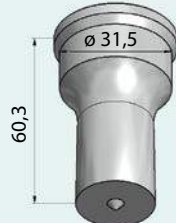

d= Best.-Nr.

17.5	RST5-0175
18.0	RST5-0180
18.5	RST5-0185
19.0	RST5-0190
19.5	RST5-0195
20.0	RST5-0200
20.5	RST5-0205
21.0	RST5-0210
21.5	RST5-0215
22.0	RST5-0220
22.5	RST5-0225
23.0	RST5-0230
23.5	RST5-0235
24.0	RST5-0240
24.5	RST5-0245
25.0	RST5-0250
25.5	RST5-0255
26.0	RST5-0260
26.5	RST5-0265
27.0	RST5-0270
27.5	RST5-0275
28.0	RST5-0280
28.5	RST5-0285
29.0	RST5-0290
29.5	RST5-0295
30.0	RST5-0300
30.5	RST5-0305
31.0	RST5-0310
31.5	RST5-0315
32.0*	RST5-0320

* Übergröße
Oversize

Rundmatrize round die

Nr. 3

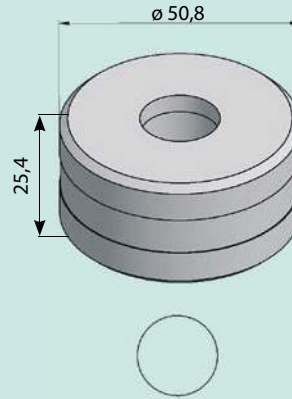

d= Best.-Nr. **d=** Best.-Nr.

3.2	RMA3-0032	22.2	RMA3-0222
3.4	RMA3-0034	22.7	RMA3-0227
3.7	RMA3-0037	23.2	RMA3-0232
4.2	RMA3-0042	23.7	RMA3-0237
4.4	RMA3-0044	24.2	RMA3-0242
4.7	RMA3-0047	24.7	RMA3-0247
5.2	RMA3-0052	25.2	RMA3-0252
5.7	RMA3-0057	25.7	RMA3-0257
6.2	RMA3-0062	26.2	RMA3-0262
6.7	RMA3-0067	26.7	RMA3-0267
7.2	RMA3-0072	27.2	RMA3-0272
7.7	RMA3-0077	27.7	RMA3-0277
8.2	RMA3-0082	28.2	RMA3-0282
8.7	RMA3-0087	28.7	RMA3-0287
9.2	RMA3-0092	29.2	RMA3-0292
9.7	RMA3-0097	29.7	RMA3-0297
10.2	RMA3-0102	30.2	RMA3-0302
10.7	RMA3-0107	30.7	RMA3-0307
11.2	RMA3-0112	31.2	RMA3-0312
11.7	RMA3-0117	31.7	RMA3-0317
12.2	RMA3-0122	32.2	RMA3-0322
12.7	RMA3-0127	32.7	RMA3-0327
13.2	RMA3-0132	33.2	RMA3-0332
13.7	RMA3-0137		
14.2	RMA3-0142		
14.7	RMA3-0147		
15.2	RMA3-0152		
15.7	RMA3-0157		
16.2	RMA3-0162		
16.7	RMA3-0167		
17.2	RMA3-0172		
17.7	RMA3-0177		
18.2	RMA3-0182		
18.7	RMA3-0187		
19.2	RMA3-0192		
19.7	RMA3-0197		
20.2	RMA3-0202		
20.7	RMA3-0207		
21.2	RMA3-0212		
21.7	RMA3-0217		

Reduzierhülse 2 / 5 Reducing sleeve 2 / 5

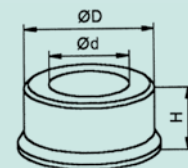

RDH 07.5612
Abmessung: Seite 7b
Dimensions: Page 7b

Modellreihe B / Model series B

Winkelstahl-Matrize
offset die

Nr. 14

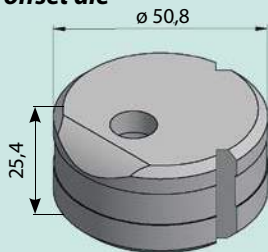

d=	Best.-Nr.
5.7	WSM14-0057
6.2	WSM14-0062
6.7	WSM14-0067
7.2	WSM14-0072
7.7	WSM14-0077
8.2	WSM14-0082
8.7	WSM14-0087
9.2	WSM14-0092
9.7	WSM14-0097
10.2	WSM14-0102
10.7	WSM14-0107
11.2	WSM14-0112
11.7	WSM14-0117
12.2	WSM14-0122
12.7	WSM14-0127
13.2	WSM14-0132
13.7	WSM14-0137
14.2	WSM14-0142
14.7	WSM14-0147
15.2	WSM14-0152
15.7	WSM14-0157
16.2	WSM14-0162
16.7	WSM14-0167
17.2	WSM14-0172
17.7	WSM14-0177
18.2	WSM14-0182
18.7	WSM14-0187
19.2	WSM14-0192
19.7	WSM14-0197
20.2	WSM14-0202
20.7	WSM14-0207
21.2	WSM14-0212
21.7	WSM14-0217
22.2	WSM14-0222
22.7	WSM14-0227
23.2	WSM14-0232
23.7	WSM14-0237
24.2	WSM14-0242
24.7	WSM14-0247

Vierkant-Stempel
square punch

Nr. 2

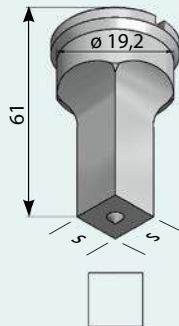

s=	Best.-Nr.
4.0	VKS2-0040
5.0	VKS2-0050
6.0	VKS2-0060
7.0	VKS2-0070
8.0	VKS2-0080
9.0	VKS2-0090
10.0	VKS2-0100
11.0	VKS2-0110
12.0	VKS2-0120
13.0	VKS2-0130

Vierkant-Stempel
square punch

Nr. 5

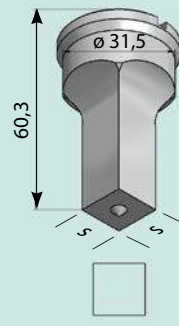

s=	Best.-Nr.
14.0	VKS5-0140
15.0	VKS5-0150
16.0	VKS5-0160
17.0	VKS5-0170
18.0	VKS5-0180
19.0	VKS5-0190
20.0	VKS5-0200
21.0	VKS5-0210
22.0	VKS5-0220

Vierkant-Matrize
square die

Nr. 3

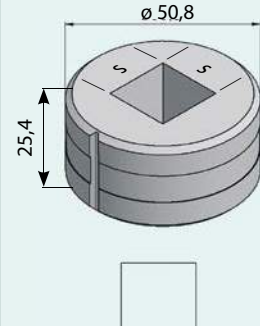

s=	Best.-Nr.
4.2	VKM3-0042
5.2	VKM3-0052
6.2	VKM3-0062
6.7	VKM3-0067
7.2	VKM3-0072
7.7	VKM3-0077
8.2	VKM3-0082
8.7	VKM3-0087
9.2	VKM3-0092
9.7	VKM3-0097
10.2	VKM3-0102
10.7	VKM3-0107
11.2	VKM3-0112
11.7	VKM3-0117
12.2	VKM3-0122
12.7	VKM3-0127
13.2	VKM3-0132
13.7	VKM3-0137
14.2	VKM3-0142
14.7	VKM3-0147
15.2	VKM3-0152
15.7	VKM3-0157
16.2	VKM3-0162
16.7	VKM3-0167
17.2	VKM3-0172
17.7	VKM3-0177
18.2	VKM3-0182
18.7	VKM3-0187
19.2	VKM3-0192
19.7	VKM3-0197
20.2	VKM3-0202
20.7	VKM3-0207
21.2	VKM3-0212
21.7	VKM3-0217
22.2	VKM3-0222
22.7	VKM3-0227
23.2	VKM3-0232
23.7	VKM3-0237

Modellreihe B / Model series B

Langlochstempel Nr. 2 oblong punch

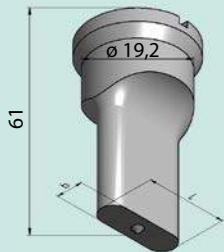

b x l	Best.-Nr.
5,0 x 10	LST2-050100
5,0 x 14	LST2-050140
5,5 x 10	LST2-055100
5,5 x 14	LST2-055140
5,5 x 19	LST2-055190
6,5 x 12	LST2-065120
6,5 x 18	LST2-065180
7,5 x 14	LST2-075140
9,0 x 14	LST2-090140
9,0 x 18	LST2-090180
10,0 x 14	LST2-100140

Langlochstempel Nr. 5 oblong punch

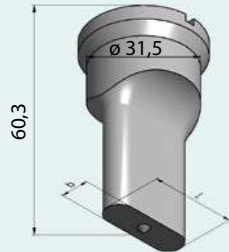

b x l	Best.-Nr.
5,5 x 25	LST5-055250
6,5 x 26	LST5-065260
6,5 x 30	LST5-065300
7,5 x 21	LST5-075210
7,5 x 26	LST5-075260
7,5 x 30	LST5-075300
9,0 x 26	LST5-090260
9,0 x 30	LST5-090300
10,0 x 20	LST5-100200
10,0 x 26	LST5-100260
10,0 x 30	LST5-100300
11,0 x 22	LST5-110220
11,0 x 26	LST5-110260
11,0 x 30	LST5-110300
12,0 x 24	LST5-120240
12,0 x 30	LST5-120300
13,0 x 26	LST5-130260
13,0 x 30	LST5-130300
14,0 x 26	LST5-140260
14,0 x 28	LST5-140280
16,0 x 26	LST5-160260
16,0 x 31	LST5-160310
18,0 x 26	LST5-180260
18,0 x 31	LST5-180310
20,0 x 31	LST5-200310
22,0 x 31	LST5-220310

Langlochmatrize Nr. 3 oblong die

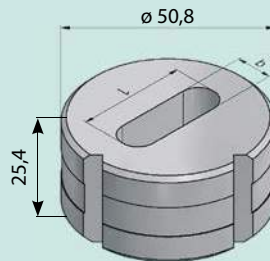

b x l	Best.-Nr.
5,2 x 10,2	LMA3-052102
5,7 x 10,7	LMA3-057107
5,2 x 14,2	LMA3-052142
5,7 x 14,7	LMA3-057147
5,7 x 10,2	LMA3-057102
6,2 x 10,7	LMA3-062107
5,7 x 14,2	LMA3-057142
6,2 x 14,7	LMA3-062147
5,7 x 19,2	LMA3-057192
6,2 x 19,7	LMA3-062197
5,7 x 25,2	LMA3-057252
6,2 x 25,7	LMA3-062257
6,7 x 12,2	LMA3-067122
7,2 x 12,7	LMA3-072127
6,7 x 18,2	LMA3-067182
7,2 x 18,7	LMA3-072187
6,7 x 26,2	LMA3-067262
7,2 x 26,7	LMA3-072267
6,7 x 30,2	LMA3-067302
7,2 x 30,7	LMA3-072307
7,7 x 14,2	LMA3-077142
8,2 x 14,7	LMA3-082147
7,7 x 21,2	LMA3-077212
8,2 x 21,7	LMA3-082217
7,7 x 26,2	LMA3-077262
8,2 x 26,7	LMA3-082267
7,7 x 30,2	LMA3-077302
8,2 x 30,7	LMA3-082307
9,2 x 14,2	LMA3-092142
9,7 x 14,7	LMA3-097147
9,2 x 18,2	LMA3-092182
9,7 x 18,7	LMA3-097187
9,2 x 26,2	LMA3-092262
9,7 x 26,7	LMA3-097267
9,2 x 30,2	LMA3-092302
9,7 x 30,7	LMA3-097307
10,2 x 14,2	LMA3-102142
10,7 x 14,7	LMA3-107147
10,2 x 20,2	LMA3-102202
10,7 x 20,7	LMA3-107207

b x l	Best.-Nr.
10,2 x 26,2	LMA3-102262
10,7 x 26,7	LMA3-107267
10,2 x 30,2	LMA3-102302
10,7 x 30,7	LMA3-107307
11,2 x 15,2	LMA3-112152
11,2 x 21,2	LMA3-112212
11,2 x 22,2	LMA3-112222
11,2 x 27,2	LMA3-112272
11,2 x 31,2	LMA3-112312
11,7 x 22,7	LMA3-117227
11,2 x 26,2	LMA3-112262
11,7 x 26,7	LMA3-117267
11,2 x 30,2	LMA3-112302
11,7 x 30,7	LMA3-117307
12,2 x 23,2	LMA3-122232
12,2 x 24,2	LMA3-122242
12,2 x 27,2	LMA3-122272
12,2 x 31,2	LMA3-122312
12,7 x 24,7	LMA3-127247
12,2 x 30,2	LMA3-122302
12,7 x 30,7	LMA3-127307
13,2 x 25,2	LMA3-132252
13,2 x 26,2	LMA3-132262
13,2 x 31,2	LMA3-132312
13,7 x 26,7	LMA3-137267
13,2 x 30,2	LMA3-132302
13,7 x 30,7	LMA3-137307
14,2 x 26,2	LMA3-142262
14,7 x 26,7	LMA3-147267
14,2 x 27,2	LMA3-142272
14,2 x 28,2	LMA3-142282
14,7 x 28,7	LMA3-147287
14,2 x 31,2	LMA3-142312
15,2 x 27,2	LMA3-152272
15,2 x 29,2	LMA3-152292
16,2 x 26,2	LMA3-162262
16,7 x 26,7	LMA3-167267
16,2 x 31,2	LMA3-162312
16,7 x 31,7	LMA3-167317
17,2 x 27,2	LMA3-172272
17,2 x 32,2	LMA3-172322
18,2 x 26,2	LMA3-182262
18,7 x 26,7	LMA3-187267
18,2 x 31,2	LMA3-182312
18,7 x 31,7	LMA3-187317
19,2 x 27,2	LMA3-192272
19,2 x 32,2	LMA3-192322
20,2 x 31,2	LMA3-202312
20,7 x 31,7	LMA3-207317
21,2 x 32,2	LMA3-212322
22,2 x 31,2	LMA3-222312
22,7 x 31,7	LMA3-227317
23,2 x 32,2	LMA3-232322

Modellreihe B / Model series B

**Langloch-
Winkelstahl-
Matrize, längs**
*oblong offset die,
longitudinal*

Nr. 14

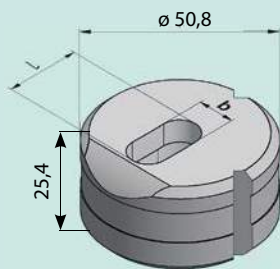

b x l Best.-Nr.

6,2 x 14,7 LWL14-062147
6,2 x 25,7 LWL14-062257
7,2 x 26,7 LWL14-072267
8,2 x 26,7 LWL14-082267
9,7 x 14,7 LWL14-097147
9,7 x 26,7 LWL14-097267
10,7 x 20,7 LWL14-107207
11,7 x 22,7 LWL14-117227
11,7 x 26,7 LWL14-117267
13,7 x 26,7 LWL14-137267
14,7 x 26,7 LWL14-147267
16,7 x 26,7 LWL14-167267

**Langloch-
Winkelstahl-
Matrize, quer**
*oblong offset die,
transverse*

Nr. 14

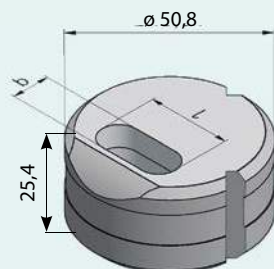

b x l Best.-Nr.

6,2 x 14,7 LWQ14-062147
6,2 x 25,7 LWQ14-062257
7,2 x 26,7 LWQ14-072267
8,2 x 26,7 LWQ14-082267
9,7 x 14,7 LWQ14-097147
9,7 x 26,7 LWQ14-097267
10,7 x 20,7 LWQ14-107207
11,7 x 22,7 LWQ14-117227
11,7 x 26,7 LWQ14-117267
13,7 x 26,7 LWQ14-137267
14,7 x 26,7 LWQ14-147267
16,7 x 26,7 LWQ14-167267

**Schlüsselloch-
Stempel**
key hole punch

Nr. 5

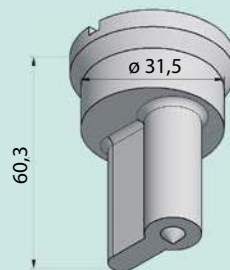

Best.-Nr.

34 x 17,5 x 10,5 SLS5-340105

**Schlüsselloch-
Matrize**
key hole die

Nr. 3

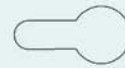
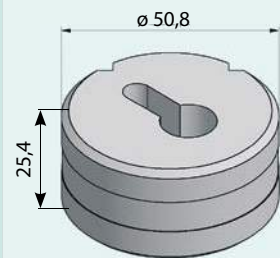

Best.-Nr.

34,2x17,7x10,7 SLM3-342107

**Eckenabrund-
Stempel**
corner radiusing punch

Nr. 5

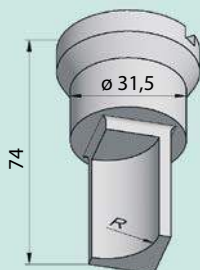

Radius Best.-Nr.

5 EAS5-000005
10 EAS5-000010
15 EAS5-000015

**Eckenabrund-
Matrize**
corner radiusing die

Nr. 3

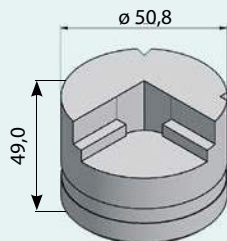

Radius Best.-Nr.

5 EAM3-000005
10 EAM3-000010
14 EAM3-000014
15 EAM3-000015

**Drehriegel-
Stempel**
hasp hole punch

Nr. 5

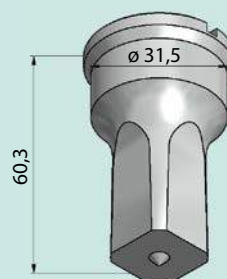

Best.-Nr.

d= 22,2 x 20,3 DHS5-222203

**Drehriegel-
Matrize**
hasp hole die

Nr. 3

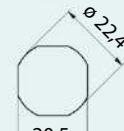
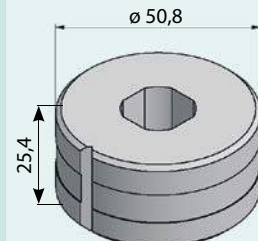

Best.-Nr.

d= 22,4 x 20,5 DHM3-224205

Modellreihe C / Model series C

Rundstempel round punch

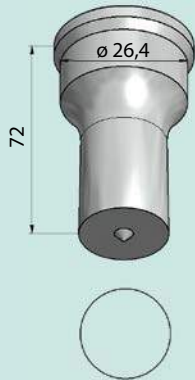

d=	Best.-Nr.	d=	Best.-Nr.
3.0	RST3-0030	22.0	RST3-0220
3.2	RST3-0032	22.5	RST3-0225
3.5	RST3-0035	23.0	RST3-0230
4.0	RST3-0040	23.5	RST3-0235
4.2	RST3-0042	24.0	RST3-0240
4.5	RST3-0045	24.5	RST3-0245
5.0	RST3-0050	25.0	RST3-0250
5.5	RST3-0055	25.5	RST3-0255
6.0	RST3-0060	26.0	RST3-0260
6.5	RST3-0065	26.5	RST3-0265
7.0	RST3-0070		
7.5	RST3-0075		
8.0	RST3-0080		
8.5	RST3-0085		
9.0	RST3-0090		
9.5	RST3-0095		
10.0	RST3-0100	Zu den Stempeln Nr. 3 können auch die Matrizen Nr. 3 Modellreihe „B“, oder die Matrizen Nr. 2 Modellreihe „A“, eingesetzt werden.	
10.5	RST3-0105		
11.0	RST3-0110		
11.5	RST3-0115		
12.0	RST3-0120		
12.5	RST3-0125		
13.0	RST3-0130		
13.5	RST3-0135		
14.0	RST3-0140		
14.5	RST3-0145		
15.0	RST3-0150	<i>Also suitable in connection with punches no. 3 are dies no. 3 type-range „B“, or dies no. 2 type-range „A“.</i>	
15.5	RST3-0155		
16.0	RST3-0160		
16.5	RST3-0165		
17.0	RST3-0170		
17.5	RST3-0175		
18.0	RST3-0180		
18.5	RST3-0185		
19.0	RST3-0190		
19.5	RST3-0195		
20.0	RST3-0200		
20.5	RST3-0205		
21.0	RST3-0210		
21.5	RST3-0215		

Nr. 3 Rundstempel round punch

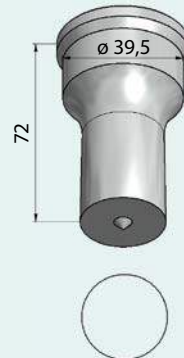

d=	Best.-Nr.
26.5	RST6-0265
27.0	RST6-0270
27.5	RST6-0275
28.0	RST6-0280
28.5	RST6-0285
29.0	RST6-0290
29.5	RST6-0295
30.0	RST6-0300
30.5	RST6-0305
31.0	RST6-0310
31.5	RST6-0315
32.0	RST6-0320
32.5	RST6-0325
33.0	RST6-0330
33.5	RST6-0335
34.0	RST6-0340
34.5	RST6-0345
35.0	RST6-0350
35.5	RST6-0355
36.0	RST6-0360
36.5	RST6-0365
37.0	RST6-0370
37.5	RST6-0375
38.0	RST6-0380
38.5	RST6-0385
39.0	RST6-0390
39.5	RST6-0395

Nr. 6 Rundmatrize round die

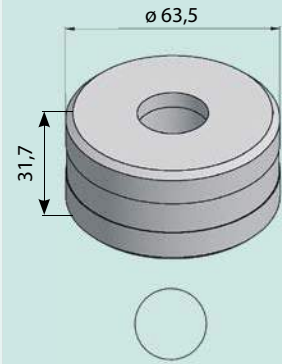

d=	Best.-Nr.
5.2	RMA4-0052
5.7	RMA4-0057
6.2	RMA4-0062
6.7	RMA4-0067
7.2	RMA4-0072
7.7	RMA4-0077
8.2	RMA4-0082
8.7	RMA4-0087
9.2	RMA4-0092
9.7	RMA4-0097
10.2	RMA4-0102
10.7	RMA4-0107
11.2	RMA4-0112
11.7	RMA4-0117
12.2	RMA4-0122
12.7	RMA4-0127
13.2	RMA4-0132
13.7	RMA4-0137
14.2	RMA4-0142
14.7	RMA4-0147
15.2	RMA4-0152
15.7	RMA4-0157
16.2	RMA4-0162
16.7	RMA4-0167
17.2	RMA4-0172
17.7	RMA4-0177
18.2	RMA4-0182
18.7	RMA4-0187
19.2	RMA4-0192
19.7	RMA4-0197
20.2	RMA4-0202
20.7	RMA4-0207
21.2	RMA4-0212
21.7	RMA4-0217
22.2	RMA4-0222
22.7	RMA4-0227
23.2	RMA4-0232
23.7	RMA4-0237
24.2	RMA4-0242
24.7	RMA4-0247

Modellreihe C / Model series C

Rundmatrize Nr. 4 round die

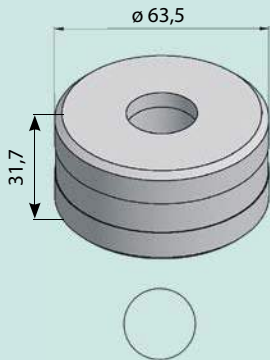

d= Best.-Nr.

25.2	RMA4-0252
25.7	RMA4-0257
26.2	RMA4-0262
26.7	RMA4-0267
27.2	RMA4-0272
27.7	RMA4-0277
28.2	RMA4-0282
28.7	RMA4-0287
29.2	RMA4-0292
29.7	RMA4-0297
30.2	RMA4-0302
30.7	RMA4-0307
31.2	RMA4-0312
31.7	RMA4-0317
32.2	RMA4-0322
32.7	RMA4-0327
33.2	RMA4-0332
33.7	RMA4-0337
34.2	RMA4-0342
34.7	RMA4-0347
35.2	RMA4-0352
35.7	RMA4-0357
36.2	RMA4-0362
36.7	RMA4-0367
37.2	RMA4-0372
37.7	RMA4-0377
38.2	RMA4-0382
38.7	RMA4-0387
39.2	RMA4-0392
39.7	RMA4-0397
40.2	RMA4-0402
40.7	RMA4-0407

Rundstempel Nr. 7 round punch

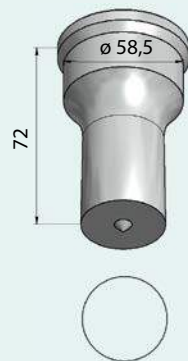

d= Best.-Nr.

40.0	RST7-0400
41.0	RST7-0410
42.0	RST7-0420
43.0	RST7-0430
44.0	RST7-0440
45.0	RST7-0450
46.0	RST7-0460
47.0	RST7-0470
48.0	RST7-0480
49.0	RST7-0490
50.0	RST7-0500
51.0	RST7-0510
52.0	RST7-0520
53.0	RST7-0530
54.0	RST7-0540
55.0	RST7-0550
56.0	RST7-0560
57.0	RST7-0570
58.0	RST7-0580

Stempelschneide Nr. 7.1 round punch

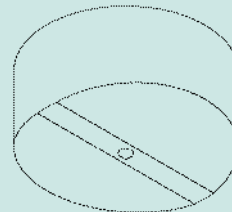

d= Best.-Nr.

60.0	STS7.1-0600
61.0	STS7.1-0610
62.0	STS7.1-0620
63.0	STS7.1-0630
64.0	STS7.1-0640
65.0	STS7.1-0650

Stempelschaft Nr. 7 punch shaft

d= Best.-Nr.

58.5	SCH7-0585
------	-----------

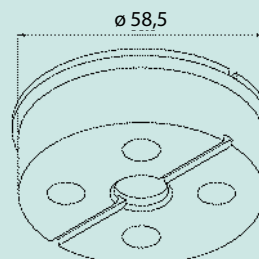

Rundmatrize Nr. 6 round die

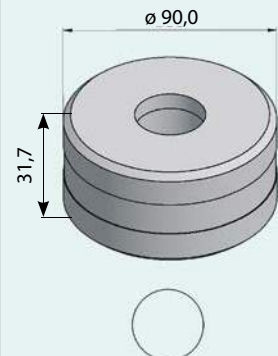

d= Best.-Nr.

40.2	RMA6-0402
40.7	RMA6-0407
41.2	RMA6-0412
41.7	RMA6-0417
42.2	RMA6-0422
42.7	RMA6-0427
43.2	RMA6-0432
43.7	RMA6-0437
44.2	RMA6-0442
44.7	RMA6-0447
45.2	RMA6-0452
45.7	RMA6-0457
46.2	RMA6-0462
46.7	RMA6-0467
47.2	RMA6-0472
47.7	RMA6-0477
48.2	RMA6-0482
48.7	RMA6-0487
49.2	RMA6-0492
49.7	RMA6-0497
50.2	RMA6-0502
50.7	RMA6-0507
51.2	RMA6-0512
51.7	RMA6-0517
52.2	RMA6-0522
52.7	RMA6-0527
53.2	RMA6-0532
53.7	RMA6-0537
54.2	RMA6-0542
54.7	RMA6-0547
55.2	RMA6-0552
55.7	RMA6-0557
56.2	RMA6-0562
56.7	RMA6-0567
57.2	RMA6-0572
57.7	RMA6-0577
58.2	RMA6-0582
58.7	RMA6-0587
59.2	RMA6-0592
59.7	RMA6-0597

Modellreihe C / Model series C

Rundmatrize Nr. 6 round die

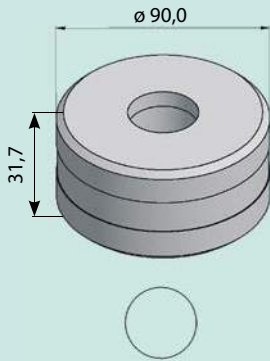

d= Best.-Nr.

60.2	RMA6-0602
60.7	RMA6-0607
61.2	RMA6-0612
61.7	RMA6-0617
62.2	RMA6-0622
62.7	RMA6-0627
63.2	RMA6-0632
63.7	RMA6-0637
64.2	RMA6-0642
64.7	RMA6-0647
65.2	RMA6-0652
65.7	RMA6-0657

Rundstempel Nr. 11 round punch

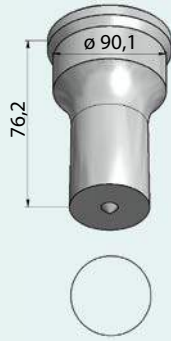

d= Best.-Nr.

plan, mit Körner flat cutting edge with center

60.0	RSK11-0600
65.0	RSK11-0650
70.0	RSK11-0700
75.0	RSK11-0750
80.0	RSK11-0800
85.0	RSK11-0850
90.0	RSK11-0900

mit Dachschriff slanted cutting edge

59.0	RST11-0590
60.0	RST11-0600
65.0	RST11-0650
70.0	RST11-0700
75.0	RST11-0750
80.0	RST11-0800
85.0	RST11-0850
90.0	RST11-0900

Stempelschneide Nr. 12 round punch

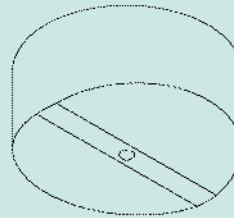

d= Best.-Nr.

95.0	STS12-0950
100.0	STS12-0100

Stempelschaft Nr. 11 punch shaft

d= Best.-Nr.

90.0	SCH11-0900
------	------------

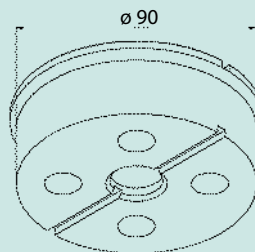

Rundmatrize Nr. 20 round die

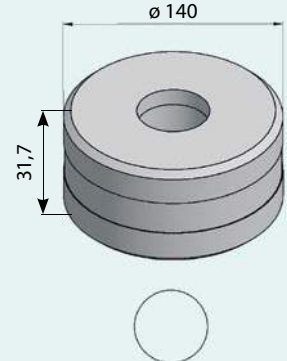

d= Best.-Nr.

70.2	RMA20-0702
70.7	RMA20-0707
75.2	RMA20-0752
80.2	RMA20-0802
80.7	RMA20-0807
85.2	RMA20-0852
90.2	RMA20-0902
90.7	RMA20-0907
95.2	RMA20-0952
100.2	RMA20-1002
100.7	RMA20-1007

Modellreihe C / Model series C

Vierkantstempel Nr. 3 square punch

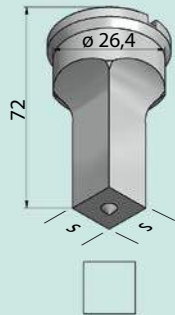

s= Best.-Nr.

8.0	VKS3-0080
9.0	VKS3-0090
10.0	VKS3-0100
11.0	VKS3-0110
12.0	VKS3-0120
13.0	VKS3-0130
14.0	VKS3-0140
15.0	VKS3-0150
16.0	VKS3-0160
17.0	VKS3-0170
18.0	VKS3-0180

Zu den Stempeln Nr. 3 können auch die Matrizen Nr. 3 aus Modellreihe „B“, oder die Matrizen Nr. 2 aus Modellreihe „A“ eingesetzt werden.

Also suitable in connection with punches no. 3 are dies no. 3, type-range „B“, or dies no. 2 type-range „A“.

Vierkantstempel Nr. 6 square punch

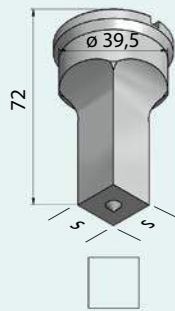

s= Best.-Nr.

19.0	VKS6-0190
20.0	VKS6-0200
21.0	VKS6-0210
22.0	VKS6-0220
23.0	VKS6-0230
24.0	VKS6-0240
25.0	VKS6-0250
26.0	VKS6-0260
27.0	VKS6-0270
28.0*	VKS6-0280

* Übergröße
* Oversize

Vierkantmatrize Nr. 4 square die

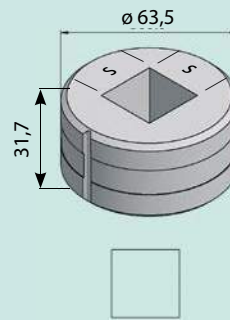

s= Best.-Nr.

17.7	VKM4-0177
18.2	VKM4-0182
18.7	VKM4-0187
19.2	VKM4-0192
19.7	VKM4-0197
20.2	VKM4-0202
20.7	VKM4-0207
21.2	VKM4-0212
21.7	VKM4-0217
22.2	VKM4-0222
22.7	VKM4-0227
23.2	VKM4-0232
23.7	VKM4-0237
24.2	VKM4-0242
24.7	VKM4-0247
25.2	VKM4-0252
25.7	VKM4-0257
26.2	VKM4-0262
26.7	VKM4-0267
27.2	VKM4-0272
27.7	VKM4-0277
28.2	VKM4-0282
28.7	VKM4-0287

Vierkantstempel Nr. 7 square punch

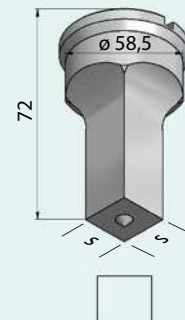

s= Best.-Nr.

30.0	VKS7-0300
35.0	VKS7-0350
40.0	VKS7-0400

Vierkantmatrize Nr. 6 square die

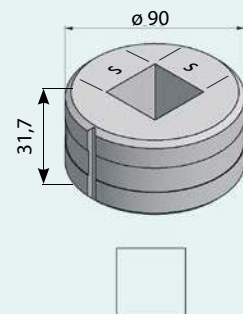

s= Best.-Nr.

30.2	VKM6-0302
30.7	VKM6-0307
35.2	VKM6-0352
35.7	VKM6-0357
40.2	VKM6-0402
40.7	VKM6-0407

Modellreihe C / Model series C

Langlochstempel Nr. 3 oblong punch

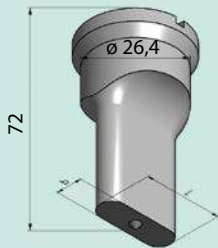

b x l **Best.-Nr.**

5,0 x 10	LST3-050100
5,0 x 14	LST3-050140
5,5 x 10	LST3-055100
5,5 x 14	LST3-055140
5,5 x 19	LST3-055190
5,5 x 25	LST3-055250
6,5 x 12	LST3-065120
6,5 x 18	LST3-065180
6,5 x 26	LST3-065260
7,5 x 14	LST3-075140
7,5 x 21	LST3-075210
7,5 x 26	LST3-075260
9,0 x 14	LST3-090140
9,0 x 18	LST3-090180
9,0 x 26	LST3-090260
10,0 x 14	LST3-100140
10,0 x 20	LST3-100200
10,0 x 26	LST3-100260
11,0 x 22	LST3-110220
11,0 x 26	LST3-110260
12,0 x 24	LST3-120240
13,0 x 26	LST3-130260
14,0 x 26	LST3-140260
16,0 x 26	LST3-160260
18,0 x 26	LST3-180260

Langlochstempel Nr. 6 oblong punch

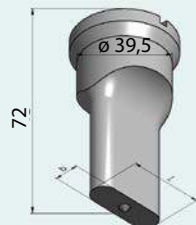

b x l **Best.-Nr.**

6,5 x 30	LST6-065300
7,5 x 30	LST6-075300
9,0 x 30	LST6-090300
10,0 x 30	LST6-100300
11,0 x 30	LST6-110300
12,0 x 30	LST6-120300
12,0 x 35	LST6-120350
13,0 x 30	LST6-130300
13,0 x 35	LST6-130350
14,0 x 28	LST6-140280
14,0 x 35	LST6-140350
16,0 x 31	LST6-160310
18,0 x 31	LST6-180310
18,0 x 36	LST6-180360
20,0 x 31	LST6-200310
22,0 x 31	LST6-220310

Langlochmatrize Nr. 4 oblong die

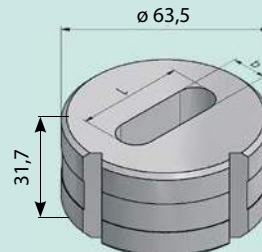

b x l **Best.-Nr.**

6,7 x 30,2	LMA4-067302
7,2 x 30,7	LMA4-072307
7,7 x 30,2	LMA4-077302
8,2 x 30,7	LMA4-082307
9,2 x 30,2	LMA4-092302
9,7 x 30,7	LMA4-097307
10,2 x 30,2	LMA4-102302
10,7 x 30,7	LMA4-107307
11,2 x 30,2	LMA4-112302
11,7 x 30,7	LMA4-117307
12,2 x 30,2	LMA4-122302
12,7 x 30,7	LMA4-127307
12,2 x 35,2	LMA4-122352
12,7 x 35,7	LMA4-127357
13,2 x 30,2	LMA4-132302
13,7 x 30,7	LMA4-137307
13,2 x 35,2	LMA4-132352
13,7 x 35,7	LMA4-137357
14,2 x 28,2	LMA4-142282
14,7 x 28,7	LMA4-147287
14,2 x 35,2	LMA4-142352
14,7 x 35,7	LMA4-147357
16,2 x 31,2	LMA4-162312
16,7 x 31,7	LMA4-167317
18,2 x 31,2	LMA4-182312
18,7 x 31,7	LMA4-187317
18,2 x 36,2	LMA4-182362
18,7 x 36,7	LMA4-187367
20,2 x 31,2	LMA4-202312
20,7 x 31,7	LMA4-207317
22,2 x 31,2	LMA4-222312
22,7 x 31,7	LMA4-227317

Zu dem Stempel Nr. 3 können auch die Matrizen Nr. 3, aus Modellreihe „B“, oder die Matrizen Nr. 2 aus Modellreihe „A“ eingesetzt werden.

Also suitable in connection with punches no. 3 are dies no. 3, type-range „B“, or dies no. 2 type-range „A“.

Modellreihe C / Model series C

Langloch-Stempel
oblong punch

Nr. 7

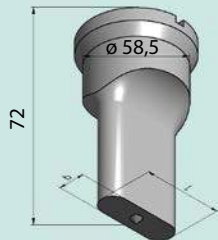

b x l **Best.-Nr.**

- 9,0 x 40,0** LST7-090400
- 10,0 x 40,0** LST7-100400
- 11,0 x 40,0** LST7-110400
- 12,0 x 40,0** LST7-120400
- 13,0 x 40,0** LST7-130400
- 14,0 x 40,0** LST7-140400
- 16,0 x 40,0** LST7-160400
- 16,0 x 55,0** LST7-160550
- 18,0 x 40,0** LST7-180400
- 18,0 x 55,0** LST7-180550
- 20,0 x 40,0** LST7-200400
- 20,0 x 55,0** LST7-200550
- 22,0 x 44,0** LST7-220440
- 22,0 x 55,0** LST7-220550

Langloch-Matrize
oblong die

Nr. 6

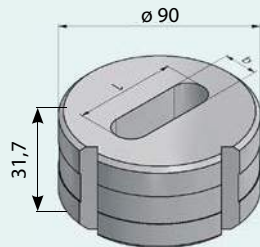

b x l **Best.-Nr.**

- 9,2 x 40,2** LMA6-092402
- 9,7 x 40,7** LMA6-097407
- 10,2 x 40,2** LMA6-102402
- 10,7 x 40,7** LMA6-107407
- 11,2 x 40,2** LMA6-112402
- 11,7 x 40,7** LMA6-117407
- 12,2 x 40,2** LMA6-122402
- 12,7 x 40,7** LMA6-127407
- 13,2 x 40,2** LMA6-132402
- 13,7 x 40,7** LMA6-137407
- 14,2 x 40,2** LMA6-142402
- 14,7 x 40,7** LMA6-147407
- 16,2 x 40,2** LMA6-162402
- 16,7 x 40,7** LMA6-167407
- 16,2 x 55,2** LMA6-162552
- 16,7 x 55,7** LMA6-167557
- 18,2 x 40,2** LMA6-182402
- 18,7 x 40,7** LMA6-187407
- 18,2 x 55,2** LMA6-182552
- 18,7 x 55,7** LMA6-187557
- 20,2 x 40,2** LMA6-202402
- 20,7 x 40,7** LMA6-207407
- 20,2 x 55,2** LMA6-202552
- 20,7 x 55,7** LMA6-207557
- 22,2 x 44,2** LMA6-222442
- 22,7 x 44,7** LMA6-227447
- 22,2 x 55,2** LMA6-222552
- 22,7 x 55,7** LMA2-227557

Schlüsselloch-Stempel
key hole punch

Nr. 6

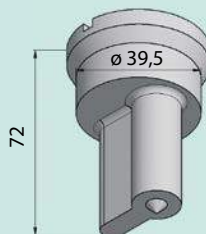

Best.-Nr.

- 34 x 17,5 x 10,5** SLS6-340105

Schlüsselloch-Matrize
key hole die

Nr. 4

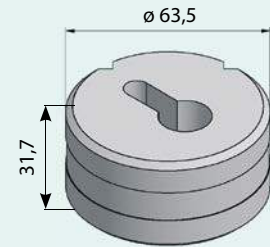

Best.-Nr.

- 34,2 x 17,7 x 10,7** SLM4-342107

Drehriegel-Stempel Nr. 3
hasp hole punch

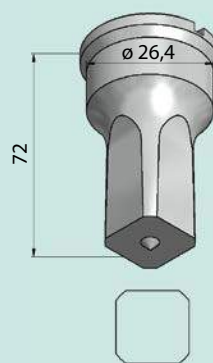

- d= 22,2 x 20,3** DHS3-222203

Zu den Stempeln Nr. 3 können die Matrizen Nr. 3 Modellreihe „B“, oder die Matrizen Nr. 2 Modellreihe „A“ eingesetzt werden.

Suitable for punches no. 3 are dies no. 3 type-range „B“, or dies no. 2 type-range „A“.

Modellreihe C / Model series C

**Ecken-
Abrundstempel**
*corner radiusing
punch*

Nr. 3

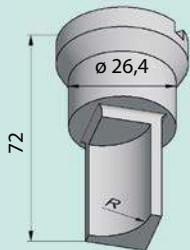

Radius	Best.-Nr.
5	EAS3-000005
10	EAS3-000010
14	EAS3-000014

**Ecken-
Abrundstempel**
*corner radiusing
punch*

Nr. 6

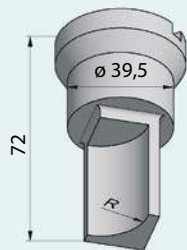

Radius	Best.-Nr.
15	EAS6-000015
20	EAS6-000020

**Ecken-
Abrundstempel**
*corner radiusing
punch*

Nr. 7

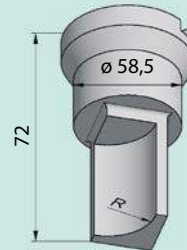

Radius	Best.-Nr.
25	EAS7-000025
30	EAS7-000030
35	EAS7-000035

**Trenn-Doppel-Abrund-
Stempel**
*shearing and double-
sided radiusing punch*

Nr. 7

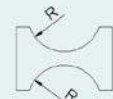
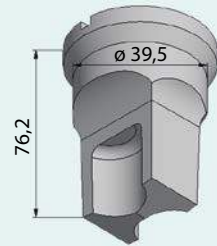

Best.-Nr.
40 x 07 TDS7=400725
R = 25

**Ecken-Abrund-
Matrize**
corner radiusing die

Nr. 4

Zu den Stempeln Nr. 3 können die Matrizen Nr. 3 Modellreihe „B“, oder die Matrizen Nr. 2 Modellreihe „A“ eingesetzt werden.

Suitable for punches no. 3 are die no. 3 type-range „B“, or dies no. 2 type-range „A“

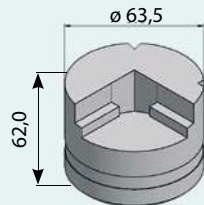

Radius	Best.-Nr.
15	EAM4-000015
20	EAM4-000020

**Ecken-Abrund-
Matrize**
corner radiusing die

Nr. 6

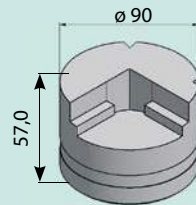

Radius	Best.-Nr.
25	EAM6-000025
30	EAM6-000030
35	EAM6-000035

nur verwendbar mit Matrizenhalter MAH 13.67... der SV d= 58

only for use with die holder MAH 13.67... of oversize punching att. d= 58

**Trenn-Doppel-
Abrund-Matrize**
shearing and double-sided radiusing die

Nr. 6

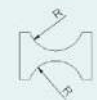
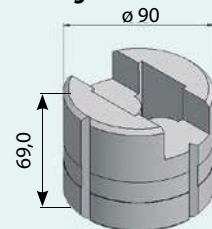

Best.-Nr.
40 x 07 TDM6-400725
R = 25

nur verwendbar mit Matrizenhalter MAH 13.67... der SV d= 58

only for use with die holder MAH 13.67.. of oversize punching att. d=58

Stempel-Übersicht / Punches overview

Nummer / Number	1	4	2	5	3	6	7	11
Modellreihe / Model serie	A	A	B	B	C	C	C	C
d= von - bis mm / from-till	3--14	8--30	3--19	17,5--32	3--26,5	26,5--39,5	40--58	59--90
Schaft d=mm / Shaft	14.4	26.4	19.2	31.5	26.4	39.5	58.5	90.1
L mm	49.2	49.2	61	60.3	72	72	72	76.2
K mm	0,8--3	1--3	0,8--3	3	0,8--3	4.5	4.5	4.5

Matrizen-Übersicht / Dies overview

Nummer / Number	2	3	4	6	20
Modellreihe / Model serie	A,B,C	A,B,C	C	C	C
d= von - bis mm / from-till	3,2--30,7	3,2--33,2	5,2--40,7	40,2--65,7	70,2--100,7
Schaft d= mm / Shaft	46.04	50.8	63.5	90	140
H mm	28.6	25.4	31.7	31.7	31.7

Winkelstahl-Matrizen-Übersicht / Offset dies overview

Nummer / Number	13	14
Modellreihe / Model serie	A	B
d= von - bis mm / from-till	5,2--22,7	5,7--24,7
Schaft d= mm / Shaft	46.04	50.8
H mm	28.6	25.4



Schneidspiel zwischen Stempel und Matrize Cutting clearance (die clearance) between punch and die

Die Größe des zu stanzenden Loches wird durch das Ist-Maß des Stempels bestimmt.
Das Schneidspiel zwischen Stempel und Matrize sollte bei ca. 10 % der zu stanzenden Materialdicke liegen.
Das Ist-Maß der Matrizenöffnung ergibt sich aus dem Ist-Maß des Stempels plus dem erforderlichen Schneidspiel (Schneidspiel = 2 x Schneidspalt).

*The size of the hole to be punched is determined by the actual size of the stamp. The cutting clearance between punch and die should be around 10% of material thickness to be punched.
The actual size of the die is derived from the actual size of the stamp plus the required cutting clearance (cutting clearance = 2 x blade clearance).*

Wenn Sie bei Ihrer Bestellung kein Maß für das Schneidspiel nennen, dann erhalten Sie Matrizen mit folgendem Spiel:

If you provide no measure for the cutting clearance with your order, you will receive dies with the following clearance:

	mm	mm	mm	mm
Stempelmaß / punch metering	bis/to 5	von/from 5 bis/to 22	von/from 22 bis/to 39,5	über/more than 39,5
Schneidspiel / cutting tolerance	0,2	0,7	1,2	0,2
Materialdicke / material thickness	bis/to 4	von/from 4 bis/to 9	von/from 9 bis/to 14	bis/to 4

Die Matrizen-Signierung entspricht dem Ist-Maß der Schneidöffnung. Dadurch können Sie Matrizen mit dem jeweils exakten Schneidspiel auswählen und bestellen.

The die lettering corresponds to the actual size of the cutting opening. This allows you to select and order dies with the exact cutting clearance.

Beispiel: Der zu stanzende Lochdurchmesser soll 25 mm betragen:

Example: The diameter of the hole to be punched should be 25 mm:

	mm	mm	mm	mm	mm
Materialdicke / material thickness	bis/to 4	von/from 4 bis/to 9	von/from 9 bis/to 14	von/from 14 bis/to 19	von/from 19 bis/to 24
Schneidspiel / cutting tolerance	0,2	0,7	1,2	1,7	2,2
Matrizenöffnung / die opening	25,2	25,7	26,2	26,7	27,2

Langlochmatrizen sind wahlweise mit 0,2 oder 0,7 mm Schneidspiel (= 2 x Schneidspiel) lieferbar.

Slotted holes dies are available with either 0.2 or 0.7 mm (= 2 x cutting clearance).

Auf Wunsch können Matrizen mit anderem Schneidspiel gefertigt werden (Mehrpreis auf Anfrage).

Matrices can be produced per request with a different cutting clearance (extra charge on request).